

# KSHZ-R1 ball valves

KSHZ-R1 ball valve is designed for automatic overlap and pressurization of the drilling instrument tube channel in drilling oil and gas wells, and also in maintenance and emergency works.

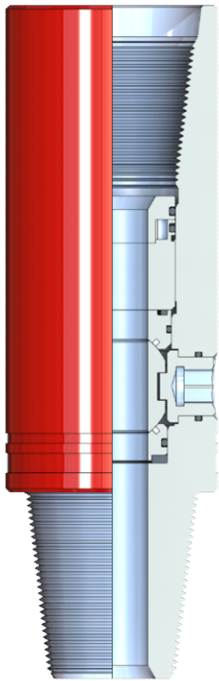

Fig. 1

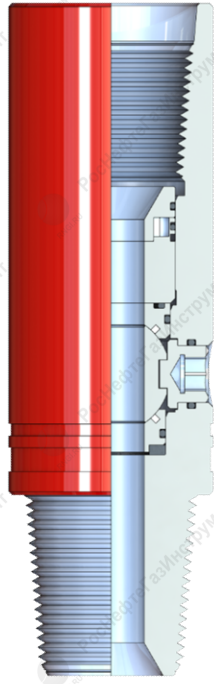

Fig. 2

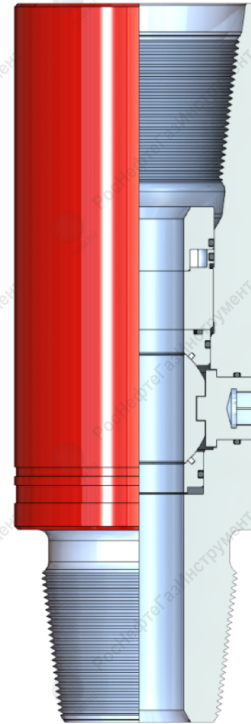

Fig. 3

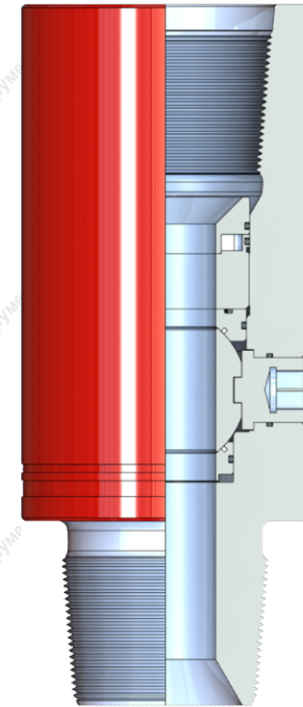

Fig. 4



## Technical characteristics

Table 1

Name	KSHZ-65R1	KSHZ-66R1	KSHZ-73R1	KSHZ-76R1	KSHZ-86R1	KSHZ-88R1	KSHZ-102R1
Equivalent	KSHC-77R1	KSHC-80R1	KSHC-86R1	KSHC-95R1	KSHC-108R1	KSHC-88R1	KSHC-120R1
Working pressure, MPa (atm)	35÷105	35÷105	35÷105	35÷105	35÷105	35÷105	35÷105
Cargo capacity kN (tf)	700 (70)	700 (70)	800 (80)	1070 (107)	1140 (114)	1200 (120)	1600 (160)
Weigh, kg	6	6	9	11	15	16	22
Length, mm	263	263	295	308	331	343	388
External diameter, mm	77	80	86	95	108	108	120
Drift size, mm	25	25	28	28	36	36	50
Coupling thread, GOST 28487	3-65	3-66	3-73	3-76	3-86	3-88	3-102
Thread profile form, GOST 28487	IV	I	IV	I	IV	I	IV
Foreign thread equivalent as per API 7 standard	NC-23	2 3/8 Reg	NC-26 (2 3/8 IF)	2 7/8 Reg	NC-31 (2 7/8 IF)	3 1/2 Reg	NC-38 (3 1/2 IF)
Item material:	steel 40X GOST 4543-71, heat treated.						
Surface:	Saddles - zinc-coating Ball - chromium coating						
Environment temperature, °C:	(-40) – (+70)						
Drawing	2	1	2	1	2	1	2
Price net of VAT, r.							

**Technical characteristics**

Table 2

Name	KSHZ-108R1	KSHZ-117R1	KSHZ-122R1	KSHZ-133R1	KSHZ-147R1	KSHZ-152R1
Equivalent	KSHC-133R1	KSHC-140R1	KSHC-146R1	KSHC-155R1	KSHC-178R1	KSHC-197R1
Working pressure, MPa (atm)	35÷105	35÷105	35÷105	35÷105	35÷105	35÷105
Cargo capacity kN (tf)	1700 (170)	2100 (210)	2200 (220)	2500 (250)	2700 (270)	4000 (400)
Weigh, kg	27	30	34	37	58	77
Length, mm	413	403	428	433	490	508
External diameter, mm	133	140	146	155	178	197
Drift size, mm	50	50	58	62	70	75
Coupling thread, GOST 28487	3-108	3-117	3-122	3-133	3-147	3-152
Thread profile form, GOST 28487	IV	I	IV	IV	III	III
Foreign thread equivalent as per API 7 standard	NC-40 (4 FH)	4 1/2 Reg	NC-46 (4 IF)	NC-50 (4 1/2 IF)	5 1/2 FH	6 5/8 Reg
Item material:	steel 40X GOST 4543-71, heat treated.					
Surface:	Saddles - zinc-coating Ball - chromium coating					
Environment temperature, °C:	(-40) – (+70)					
Drawing	4	3	4	4	4	4
Price net of VAT, r.						